

## HST HUDSON

### FAST CREW SUPPLIER 2710

FAST TWIN AXE CREW SUPPLY VESSEL



#### GENERAL

Hull materials	Aluminium
Superstructure	Aluminium
Basic functions	Crew and cargo duties
Classification	Bureau Veritas Hull • MACH Light Ship / Fast Utility Vessel Sea Area 3
Flag	MCA HS-OSC code

#### DIMENSIONS

Length overall	26.8 m
Beam overall	10.8 m
Depth at sides	4.3 m
Draught	2.1 m
Deadweight	30.0 t
Cargo deck area	80.0 m <sup>2</sup>
Deck load	1.5 t/m <sup>2</sup>
Crew	8 persons
(Industrial) personnel	26 persons

## TANK CAPACITIES

Fuel oil	14.0 m <sup>3</sup>
Fuel trim	16.0 m <sup>3</sup>
Fresh water	3.5 m <sup>3</sup>
Sewage	0.9 m <sup>3</sup>
Bilge water/ dirty oil	0.4 m <sup>3</sup>

## PERFORMANCES

Speed	25.0 kn
Range at max. speed	600 - 1200 nm

## PROPULSION SYSTEM

Main engines	2x Caterpillar C32 TTA
Total Power	2162 bkW
Gearboxes	2x Reintjes "ZWVSA series (two speed)
Propulsion	2x Fixed-pitch propellers
Bow Thrusters	2x 64 kW, hydraulically driven

## ELECTRICAL EQUIPMENT

Network	24V d.c., 400/230V 50 Hz a.c.
Generator sets	2x 38.0 ekW-47.5 kVA

## DECK LAY-OUT

Anchor equipment	1x 150 kg SHHP
Fendering	Rubber "D" type and heavy duty foam fender
Anchor winch	Electrically driven
Moon pool	
Foldable deck crane	Heila HLM 20-2S

## SHIP SYSTEMS

General service pump	2x electrically driven
Fuel trim system	2x 2800 l/hr at 4 bar
Engine room ventilation	8.000 m <sup>3</sup> /hr in each engine room
Fire extinguishing	Hand operated fire extinguishers, Fixed Fi-Fi system in engine room (Novec 1230)
Fuel cargo system	Connected to fuel trim system

## ACCOMMODATION

Below main deck	2x crew cabin, 2x harbour cabin
Main deck	26 personnel seats, crew cabins, wet gear room, pantry, mess room and sanitary spaces
Bridge deck	Navigation console, small crew mess
Air conditioning	112.000 BTU/hr

## NAUTICAL AND COMMUNICATION EQUIPMENT

Searchlight	1x
Radar	2x X-band
Electronic charts	Dual ECDIS system
DGPS	1x
AIS	1x
Compass	1 x Magnetic, 1 x GPS
Autopilot	1x
Echo sounder	1x
Speed log	1 x, Doppler log
Internal communication	Intercom and loudhailer CCTV system
External communication	GMDSSA2
Weather system	1x

## OPTIONAL

Satellite data communication
External communication GMDSS A3
Fleet broadband IV-SAT
Wi-fi system

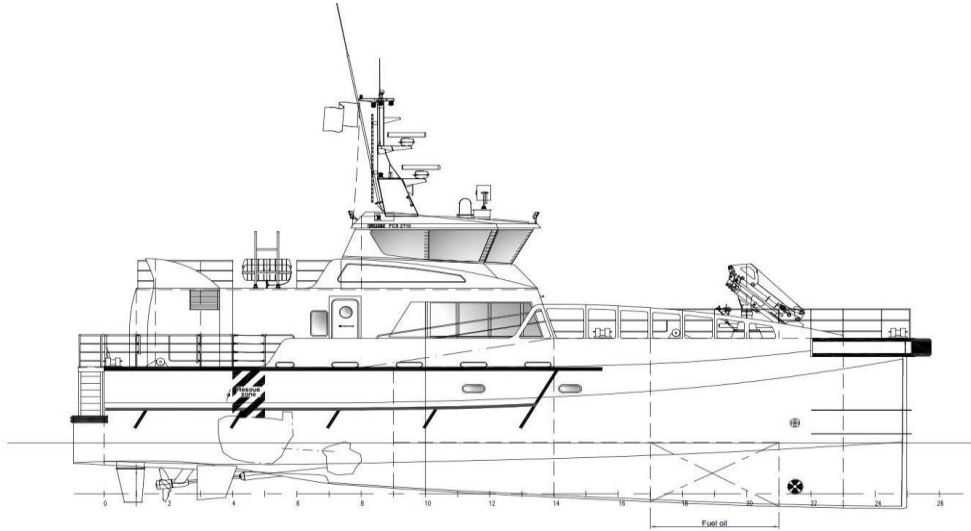

Profile

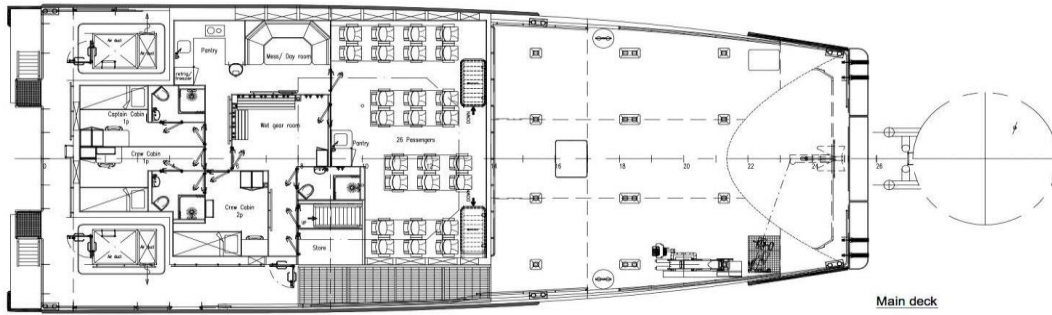

Main deck

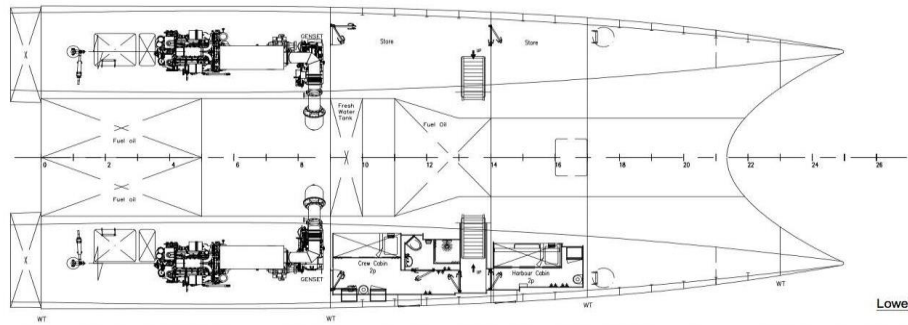

Lower deck

